



Alexander Hudson Estates

Sales Particulars

Alexander Hudson Estates

Forest Gate, Palmersville, NE12

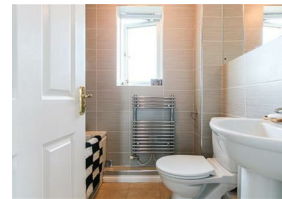

The Property

Alexander Hudson Estates introduces to market this three-bedroom, terraced family home with allocated parking and spacious rear garden in the popular residential area of Forest Gate, NE12. Close-by to a range of local amenities, transport links and schooling.

Immaculately presented throughout, this delightful home boasts a welcoming entrance hallway, the ground floor features a conveniently located WC, ideal for guests, alongside a spacious living room that provides a cozy retreat. The open-plan kitchen diner is a true highlight, with ample space for both cooking and entertaining, and French doors that open up to a beautifully maintained rear garden, allowing natural light to flood the area while providing a seamless connection to the outdoors.

On the first floor, you'll find three bright and airy bedrooms, each with generous proportions and large windows, ensuring a comfortable and relaxing environment. The family bathroom is stylishly appointed, with modern fixtures and finishes. To the rear, a landscaped garden, perfect for enjoying those warm, summer months.

The property lies just a 5-minute drive (or 15-minute walk) from a large supermarket and is a similar distance from The Rising Sun Country Park, a green oasis with ponds, woodlands and extensive grasslands, the site is an ideal place to relax and enjoy the great outdoors. Killingworth Shopping Centre is also only a 10 minute drive, offering another large supermarket and various high street shops; whilst The Lakeside Centre is also close by, a leisure centre which offers a swimming pool, indoor sports courts, a gym and a soft play for children. Palmersville Metro Station and the A19 offer ease of access across Newcastle and further afield.

Freehold
Council Tax: B
EPC Rating: 76

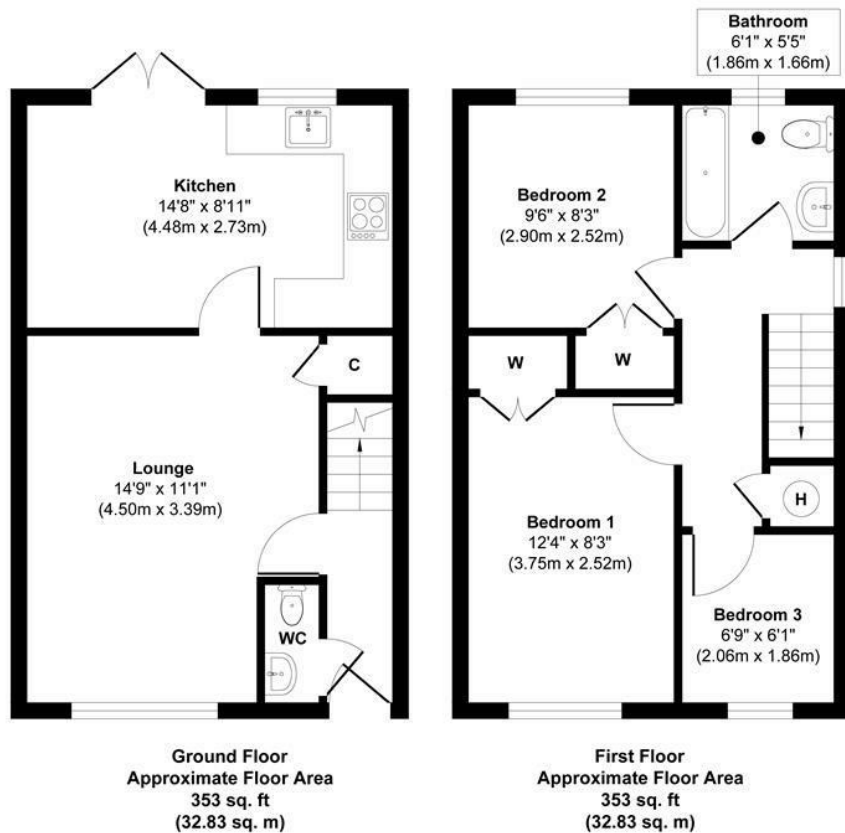

Approx. Gross Internal Floor Area 707 sq. ft / 65.67 sq. m

Illustration for identification purpose only, measurements approximate and not to scale, unauthorized reproduction is prohibited. All rights reserved for Alexander Hudson Estates

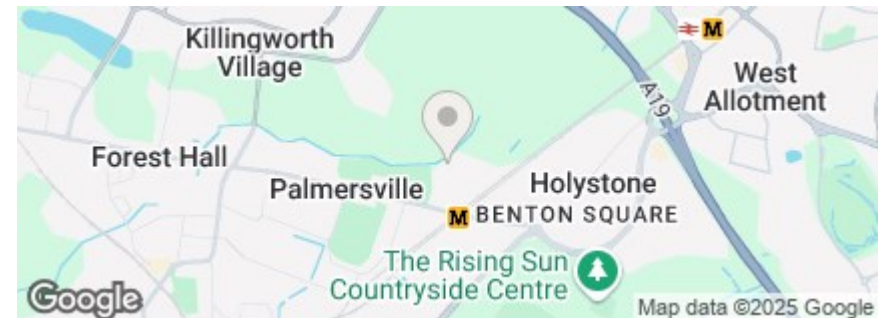



Alexander Hudson Estates
The Printworks
20 Arrow Close
NE12 6QN

0191 268 7433
sales@alexanderhudson.co.uk